

S952B - S953B - S954B - S955B - S956B - S957B

PORTA SMARTPHONE/NAVIGATORE DA MANUBRIO GPS/SMARTPHONE-HOLDER FOR HANDLEBAR PORTE-GPS/SMARTPHONE POUR GUIDON
GPS/SMARTPHONE-HALTER FÜR LENKER PORTA-NAVEGADOR/SMARTPHONE PARA LOS MANILLARES - PORTA SMARTPHONE/GPS PARA GUIDÃO

N°	Descrizione	Caratteristiche	Codice	Quantità
1	S952B / S953B / S954B / S955B S956B / S957B	-	-	1
2	Fascetta - Clamp Pince - Klemme Abrazadera - Braçadeira	-	-	1
3	Coprivite - Screw Cap Cache Vis - Stoppschraube Tapa Tornillo - Tampa do Parafuso	-	-	2
4	Cinghia Di Sicurezza - Fastening Belt Courroie De Fixation - Befestigungsgurt Correa De Sujeción - Cinto De Fixação	-	-	1
5	Riduzione - Reductor Réducteur - Reduktor Reductor - Redutor	-	Z2345	1
6	Adesivo - Sticker - Adhésif - Adhesivo - Aufkleber - Adesivo	-	Z9182	1

S952B

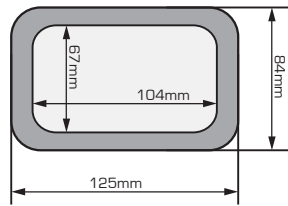
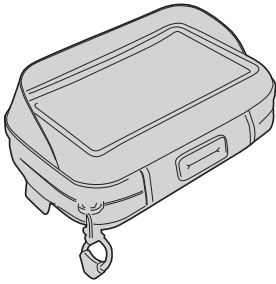

S955B

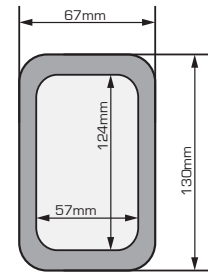
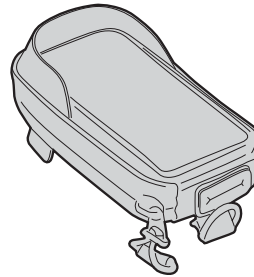

S953B

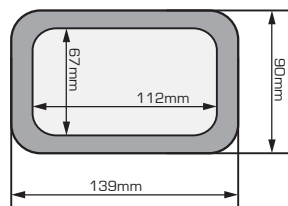
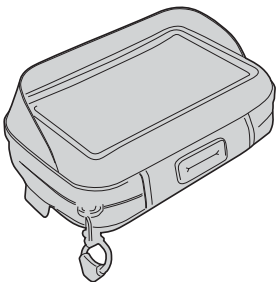

S956B

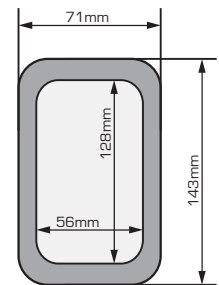
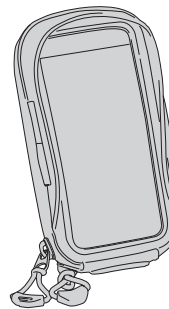

S954B

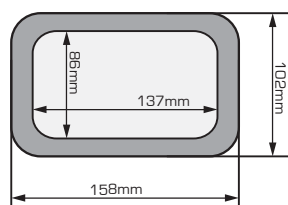
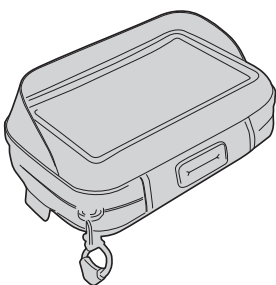

S957B

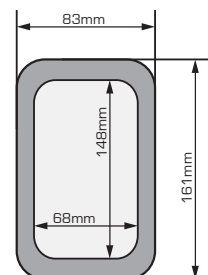
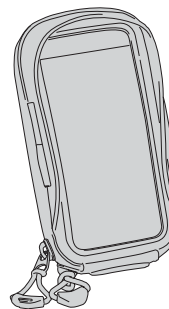

S952B - S953B - S954B - S955B - S956B - S957B

PORTA SMARTPHONE/NAVIGATORE DA MANUBRIO GPS/SMARTPHONE-HOLDER FOR HANDLEBAR PORTE-GPS/SMARTPHONE POUR GUIDON
GPS/SMARTPHONE-HALTER FÜR LENKER PORTA-NAVEGADOR/SMARTPHONE PARA LOS MANILLARES - PORTA SMARTPHONE/GPS PARA GUIÃO

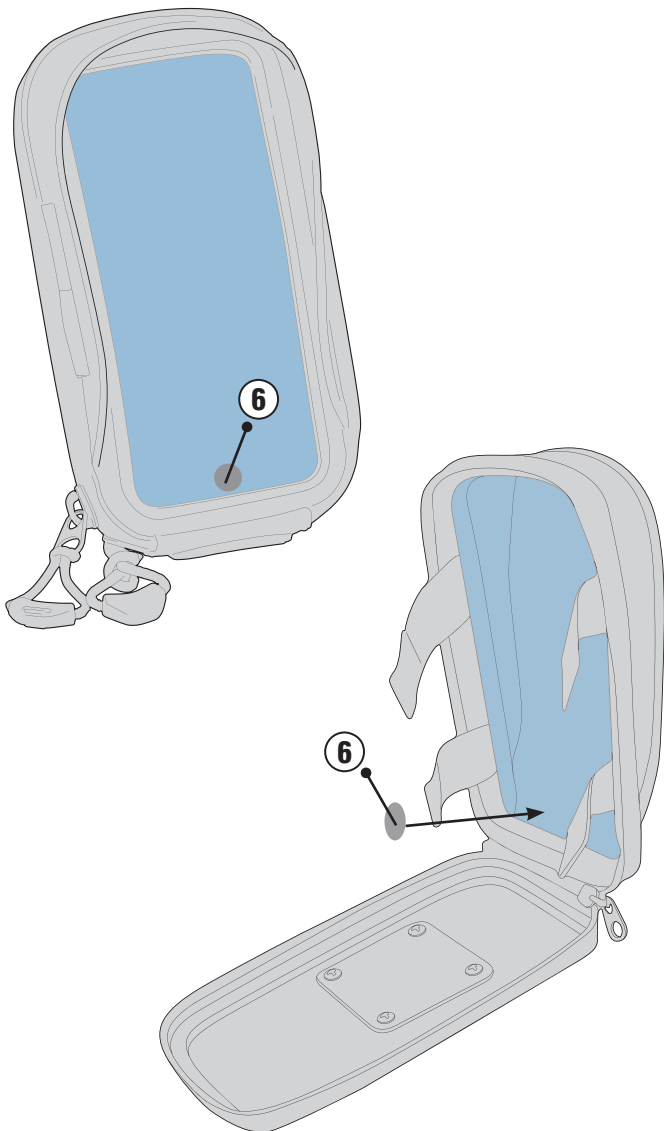
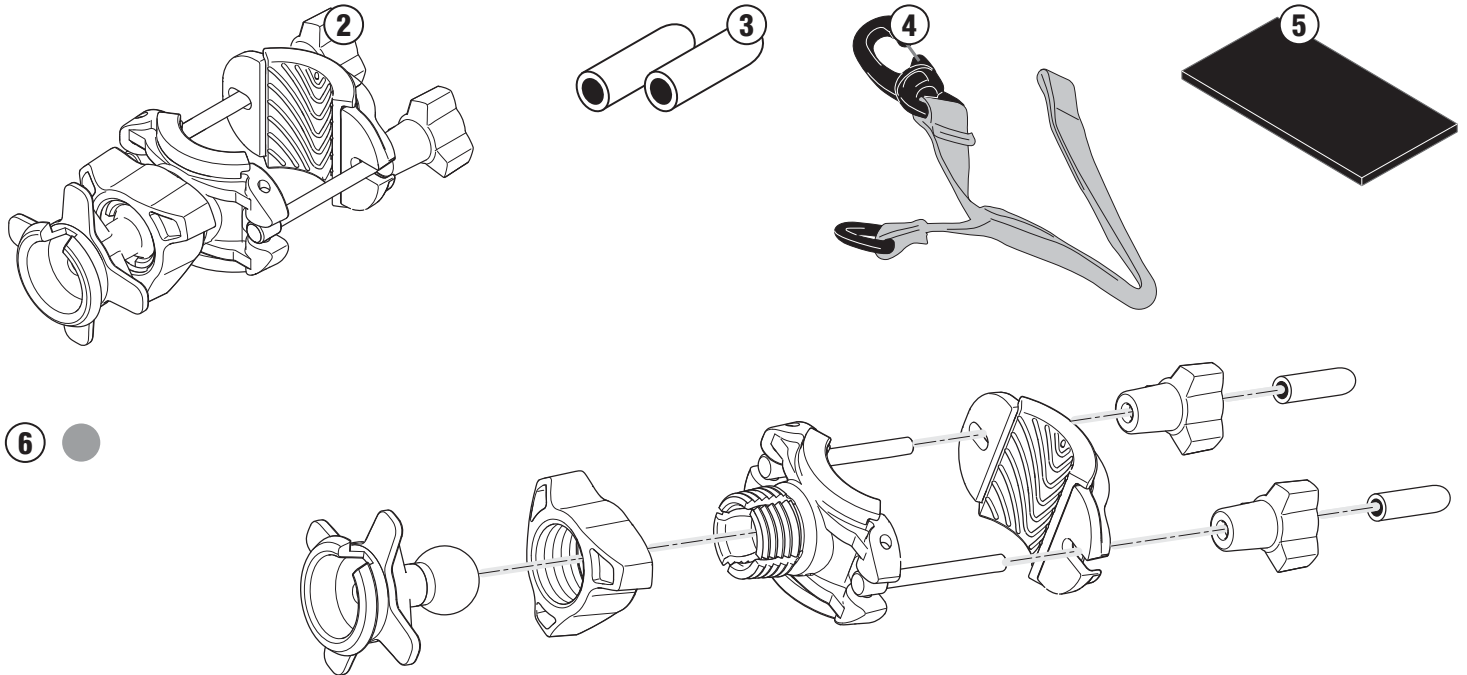

ONLY FOR: S954B, S956B, S957B

IT: Fissare l'adesivo Z9182 all'interno della plastica protettiva dello schermo in corrispondenza del pulsante virtuale (per esempio: Iphone 7 / 7 Plus)

EN: Attach part Z9182 inside the plastic screen protector at the precise location of the virtual "home" button on the mobile phone (eg: for Iphone 7 / 7 plus).

DE: Kleben Sie das Z9182 im Inneren des Sichtfensters, an der Position der Home-Taste von Ihrem Handy (zum Beispiel bei iPhone 7 / 7 Plus).

Tutti i marchi e i modelli dei dispositivi sono di proprietà dei rispettivi titolari.

All Trademarks, Names and PDA models are property of the respective Companies.

Toutes les marques, les noms et les modèles déposés sont la propriété respective de leurs compagnies.

Todas las marcas y modelos de los dispositivos son propiedad de sus respectivos titulares.

Alle Marken, Namen und Modellebezeichnungen sind Eigentum der jeweiligen Unternehmen.

Todas as marcas e modelos de dispositivos são propriedade dos seus respectivos proprietários.

S952B - S953B - S954B - S955B - S956B - S957B

PORTA SMARTPHONE/NAVIGATORE DA MANUBRIO GPS/SMARTPHONE-HOLDER FOR HANDLEBAR PORTE-GPS/SMARTPHONE POUR GUIDON
GPS/SMARTPHONE-HALTER FÜR LENKER PORTA-NAVEGADOR/SMARTPHONE PARA LOS MANILLARES - PORTA SMARTPHONE/GPS PARA GUIDÃO

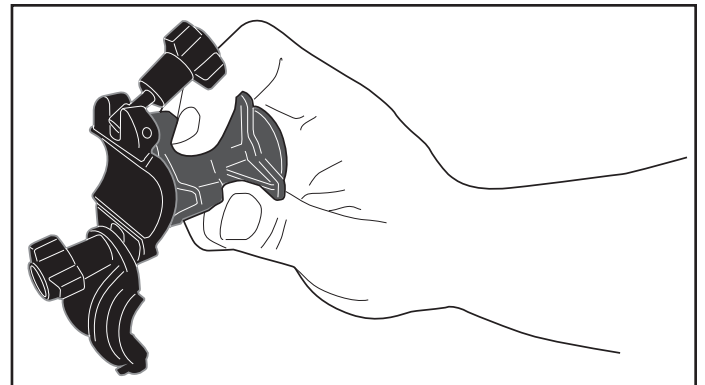
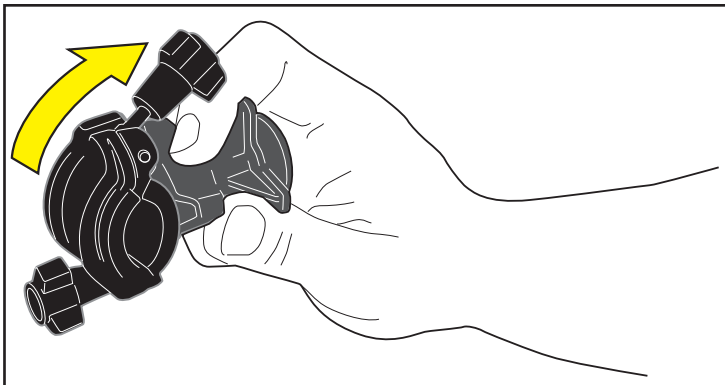
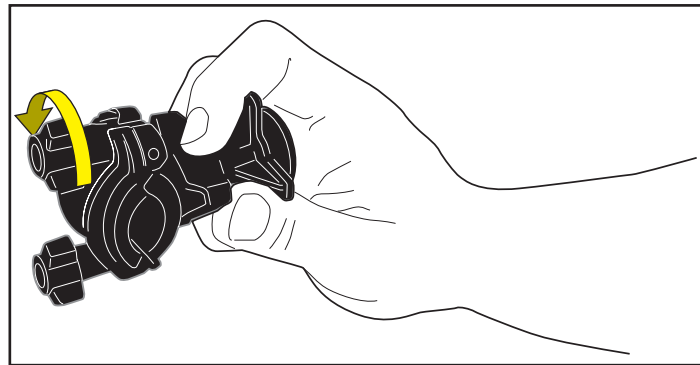
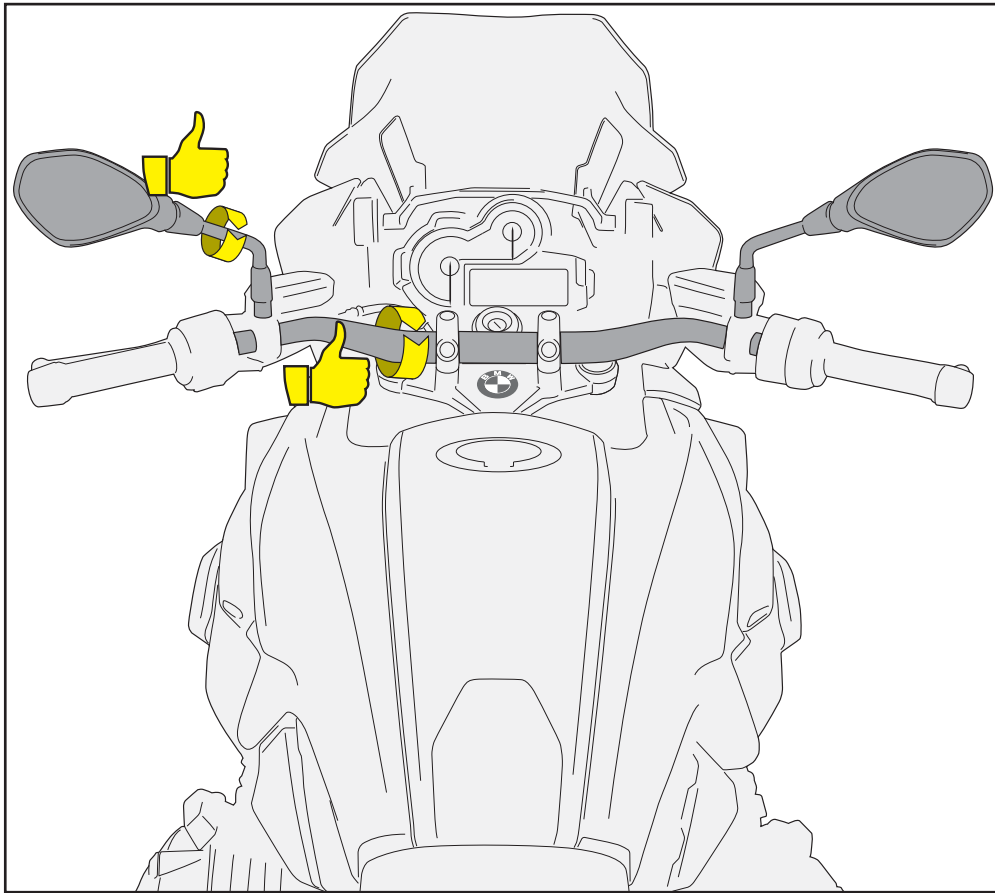

S952B - S953B - S954B - S955B - S956B - S957B

PORTA SMARTPHONE/NAVIGATORE DA MANUBRIO GPS/SMARTPHONE-HOLDER FOR HANDLEBAR PORTE-GPS/SMARTPHONE POUR GUIDON
GPS/SMARTPHONE-HALTER FÜR LENKER PORTA-NAVEGADOR/SMARTPHONE PARA LOS MANILLARES - PORTA SMARTPHONE/GPS PARA GUIÃO

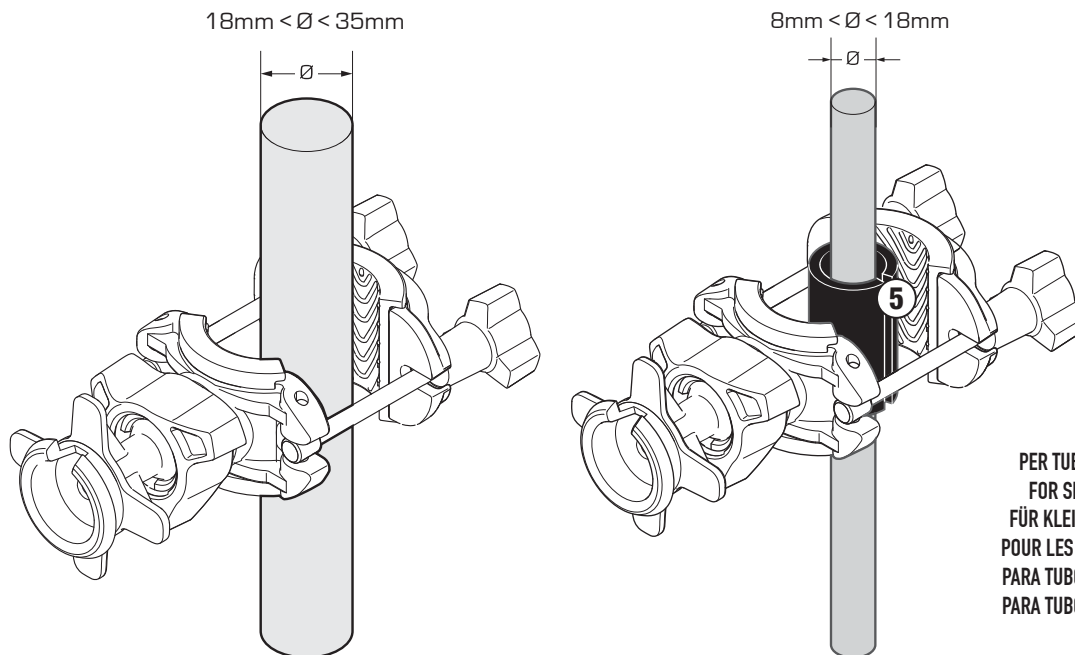

AGGANCI
COUPLING
COUPLAGE
KOPPLUNG
ENGANCHE
ACOPLAMENTO

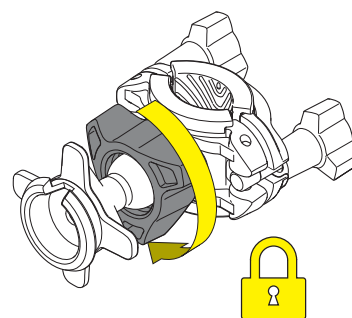
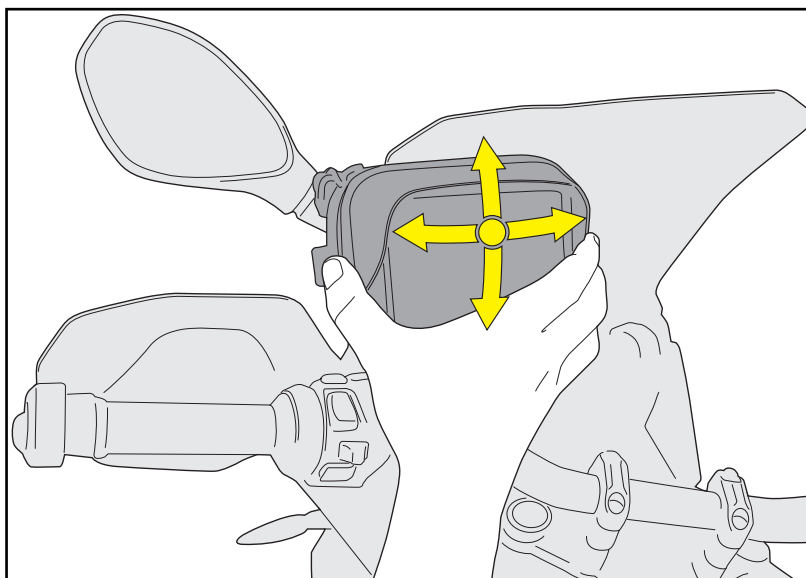
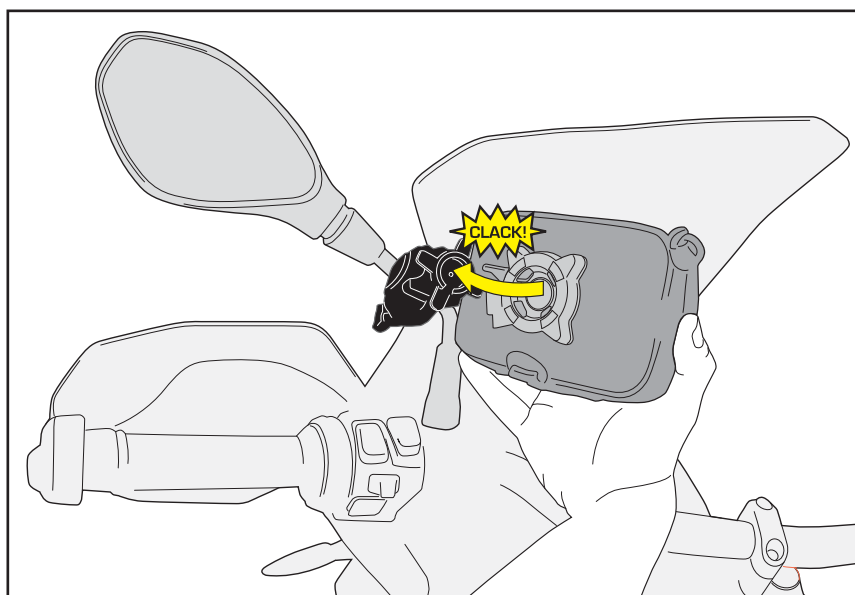

ISTRUZIONI DI MONTAGGIO - MOUNTING INSTRUCTIONS
INSTRUCTIONS DE MONTAGE - BAUANLEITUNG
INSTRUCCIONES DE MONTAJE - INSTRUÇÕES DE MONTAGEM

S952B - S953B - S954B - S955B - S956B - S957B

PORTA SMARTPHONE/NAVIGATORE DA MANUBRIO GPS/SMARTPHONE-HOLDER FOR HANDLEBAR PORTE-GPS/SMARTPHONE POUR GUIDON
GPS/SMARTPHONE-HALTER FÜR LENKER PORTA-NAVEGADOR/SMARTPHONE PARA LOS MANILLARES - PORTA SMARTPHONE/GPS PARA GUIDÃO

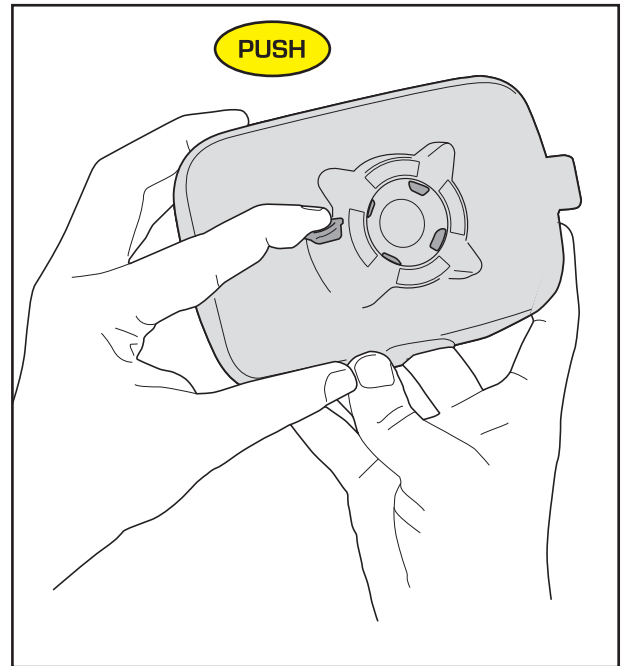
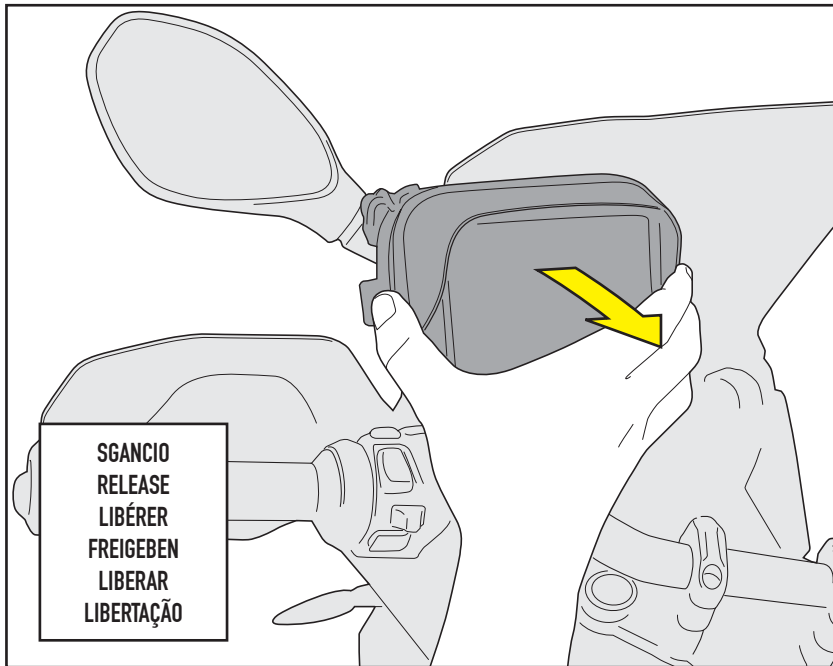

CINGHIA DI SICUREZZA - FASTENING BELT - COURROIE DE FIXATION - BEFESTIGUNGSGURT - CORREA DE SUJECIÓN - CINTO DE FIXAÇÃO

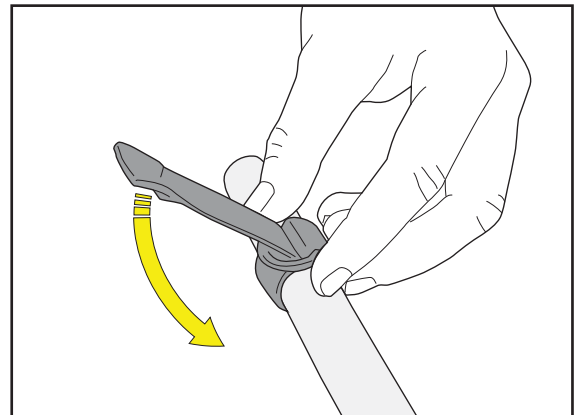
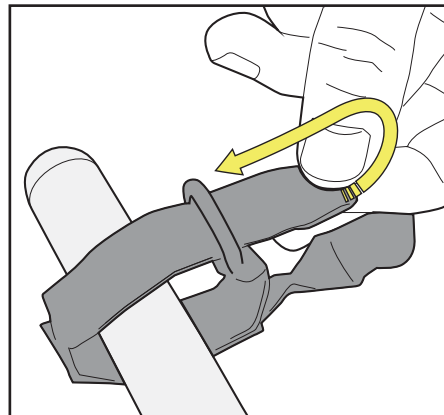
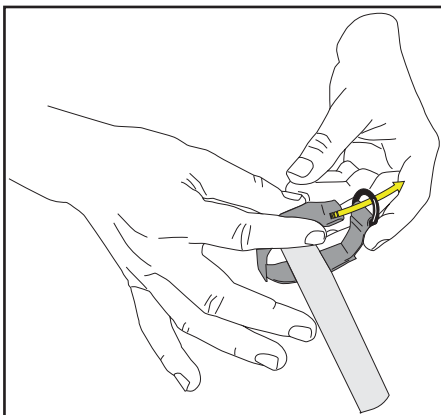
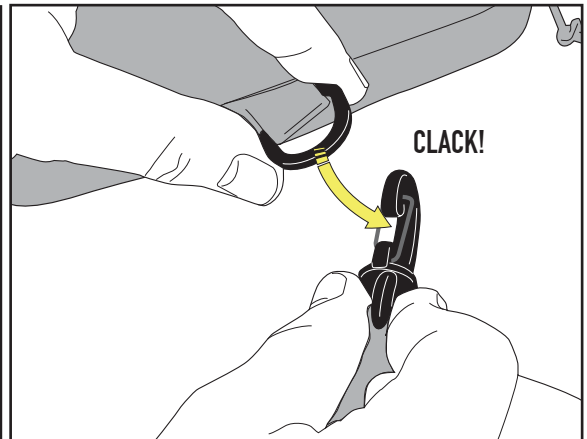
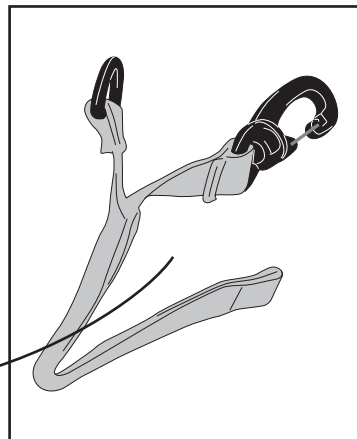
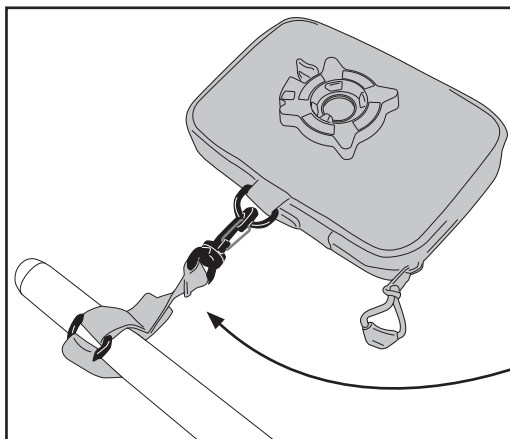

ATTENZIONE: GIVI RACCOMANDA L'USO DELLA CINGHIA DI SICUREZZA E DECLINA OGNI RESPONSABILITÀ IN CASO DI MANCATO UTILIZZO

CAUTION: SECURITY STRAP MUST BE USED, GIVI CANNOT BE HELD RESPONSIBLE IF NOT USED

VORSICHT! VERWENDEN SIE DIE SICHERHEITSGURTE! WIR LEHNEJEN JEDE HAFTUNG AB, DIE DURCH UNSACHGEMÄSSE HANDHABUNG DER TASCHEN VERURSACHT WURDE.